

the offices at
**DOWNTOWN
COLUMBIA**

TWO
MERRIWEATHER
10960 GRANTCHESTER WAY



FEATURES

- 130,000 SF LEED SILVER CERTIFIED OFFICE BUILDING WITH 9,000 SF OF GROUND-LEVEL RETAIL
- LOCATED ACROSS THE PLAZA FROM CURED, 18TH & 21ST AND THE ONE MERRIWEATHER DELI
- 5TH FLOOR OUTFITTED WITH FIVE SPEC SUITES OF VARYING SIZES
- AMPLE PARKING SPACES WITH AUTONOMOUS PARKING THROUGH STEER
- LOBBY-LEVEL MARKETING CENTER WITH FULL AUDIO-VISUAL CAPABILITIES AND SPACE FOR LARGE MEETINGS AND EVENTS

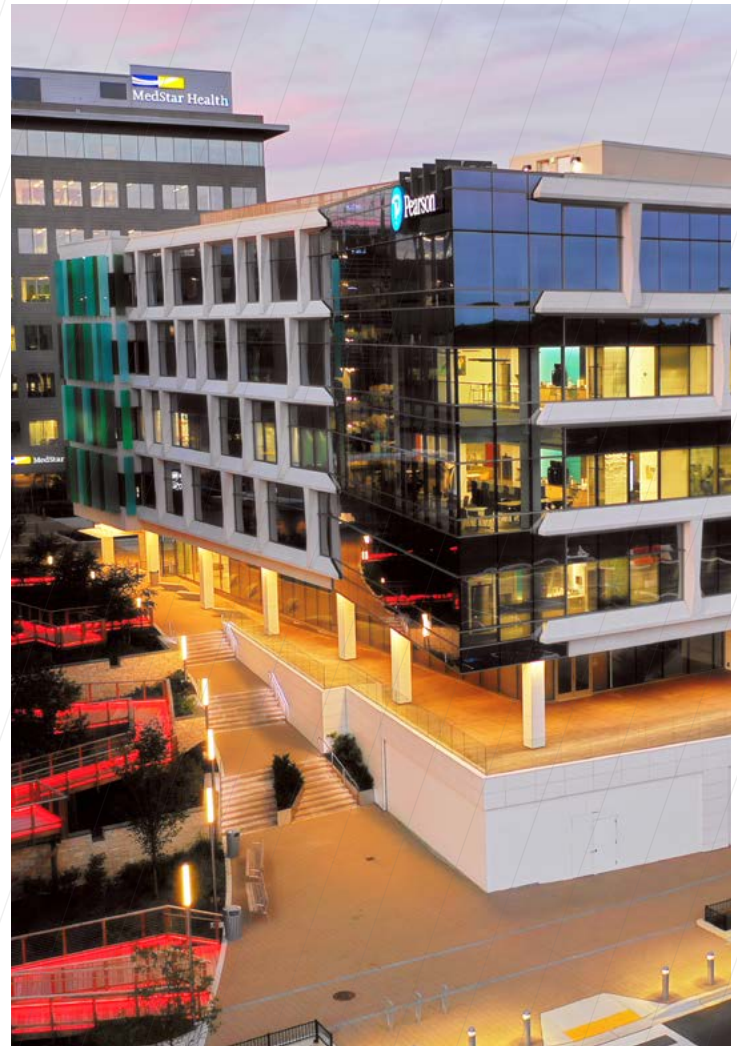



THE PERFECT LOCATION

- CLOSE PROXIMITY TO BALTIMORE, ANNAPOLIS, MONTGOMERY COUNTY AND WASHINGTON, D.C.
- EASY ACCESS TO I-95, ROUTE 29, I-70, ROUTE 100 AND ROUTE 32
- 20-MINUTE DRIVE TO BWI AMTRAK STATION WITH HIGH-SPEED CONNECTIONS TO D.C., PHILADELPHIA AND NEW YORK CITY
- WITHIN 9-MILE RADIUS OF NSA AND FORT MEADE

LET'S TALK

FOR LEASING INFORMATION

Alex Hancock - EVP, Transwestern

202.999.8175

ALEX.HANCOCK@TRANSWESTERN.COM



Merriweather
District

OFFICESATDTC.COM

Howard Hughes